



## Multi-Level Hand-Cranked Roll out Sheet Metal Rack for Heavy-Duty Sheet/Plate Storage

Our Product Introduction

for more products please visit us on [warehouse-rackings.com](http://warehouse-rackings.com)

### Basic Information



### Product Specification

- Model NO.: QF-Sheet Racking
- Material: Steel
- Structure: Drawer
- Type: Multi-Level Racking
- Mobility: Combined
- Height: 0-5m
- Weight: Customized
- Closed: Semi-closed
- Development: New Type
- Serviceability: For Special Purpose
- Color: Customized
- Lead Time: 20 Days
- Surface Treatment: Powder Coating
- Feature: Anti-Wear/Anti-Rust
- Transport Package: Standard Export Packing



### More Images

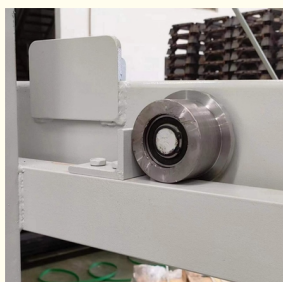

## Product Description

### Product Description

**A roll-out sheet rack** is a type of storage system that allows for easy access and organization of large, flat sheets like metal, wood, or plastic.



<b>Brand Name</b>	Qifei
<b>Product name</b>	Warehouse Heavy Duty Hand Cranked Metal Sheet Racking
<b>Length</b>	Customized
<b>Width</b>	Customized
<b>Height</b>	Customized
<b>Capacity</b>	hundreds to thousands kg/layer
<b>Material</b>	Q235B
<b>OEM&amp;ODM</b>	Available
<b>Surface Treatment</b>	Galvanized/Powder Coating
<b>Color</b>	Customized
<b>Sample</b>	Available
<b>General Use</b>	Warehouse Shelving/Rack, manufacturing or construction environments etc.
<b>HS CODE</b>	730890
<b>Packaging Details</b>	Plastic banding+Stretch film wrapped

### The key features and parameters of a roll-out sheet rack include:

#### **Rack Construction:**

**Frame material:** Often made of steel, aluminum for strength and durability.

**Roller system:** Smooth-rolling casters or bearings that allow the racks to extend out.

**Shelving:** Adjustable, reinforced shelves to hold the sheet materials.

**Capacity:** The maximum weight the rack can safely support, typically ranging from hundreds to thousands of pounds.





### Roll-Out Mechanism:

**Extension length:** How far the rack can roll out from the stationary frame.

**Locking system:** To secure the rack in the extended or retracted positions.

**Ergonomics:** The ease of operating the roll-out mechanism.

### Sheet Retention:

**Retaining lips or guides:** To prevent sheets from sliding off the shelves.

**Adjustable stops:** To customize the shelf depth for different sheet sizes.

**Anti-tilt features:** To improve stability and safety when extended.

### Dimensions:

**Rack size:** Width, depth, and height to accommodate the desired sheet sizes.

**Shelf spacing:** Vertically adjustable to fit different sheet thicknesses.

### Safety and Compliance:

**Load ratings:** Ensuring the rack can safely support the intended weights.

**Stability:** Preventing tipping or collapse when extended or loaded.

**Regulatory standards:** Meeting any industry or workplace safety requirements.



The specific parameters will depend on **the application, sheet materials, volume, and workflow needs**. Proper selection and installation of a roll-out sheet rack can greatly improve organization, accessibility, and efficiency in sheet material storage and handling.

**If you have any need, don't hesitate, just contact us!**

### Our Advantages

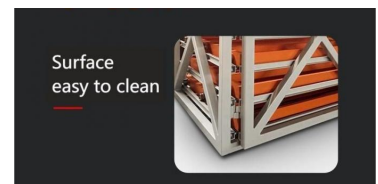
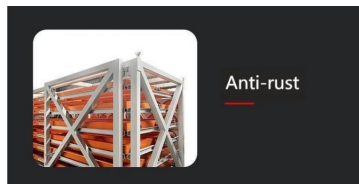
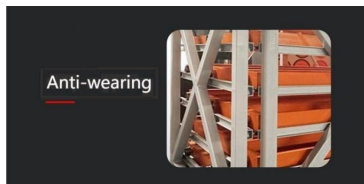





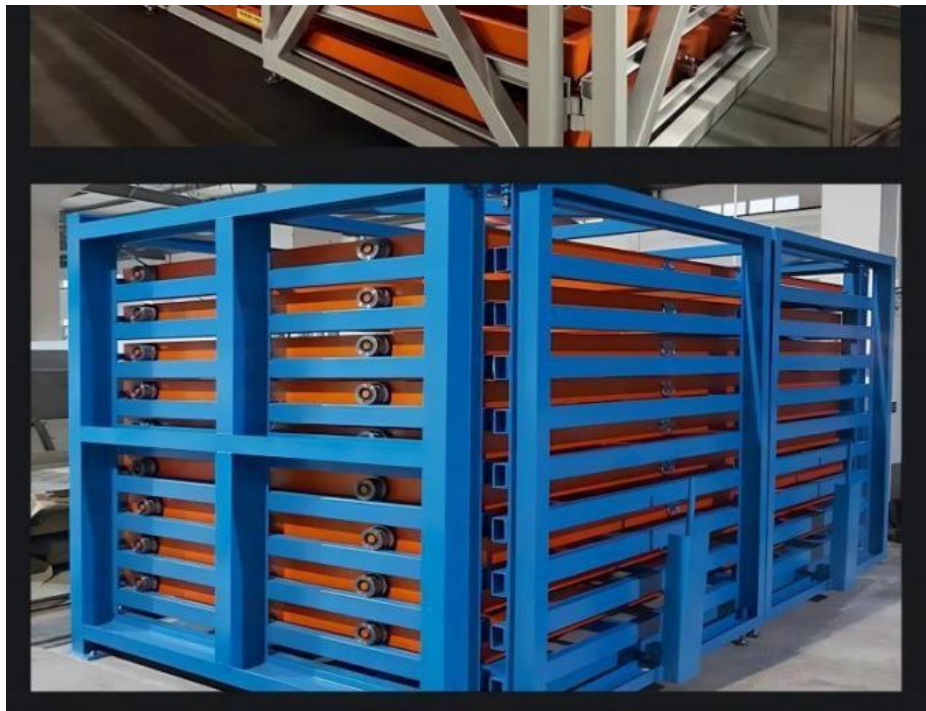

## Company Profile

**Welcome to visit our company**

### Jiangsu Qifei Intelligent Storage Equipment Co., Ltd



Established in 2020, is one of the leading manufacturer specialized in industrial warehouse storage equipment



Main products are heavy/medium/light duty rack, cantilever rack, mezzanine floor, drive in rack, and so on.



We aim to provide cost-effective and space utilization storage solutions for all customers worldwide



### WHY CHOOSE US



Customization



Free Design



Best Price

## Co-operation Process

## Customized Procedure

One-stop Service  
7\*24h on line

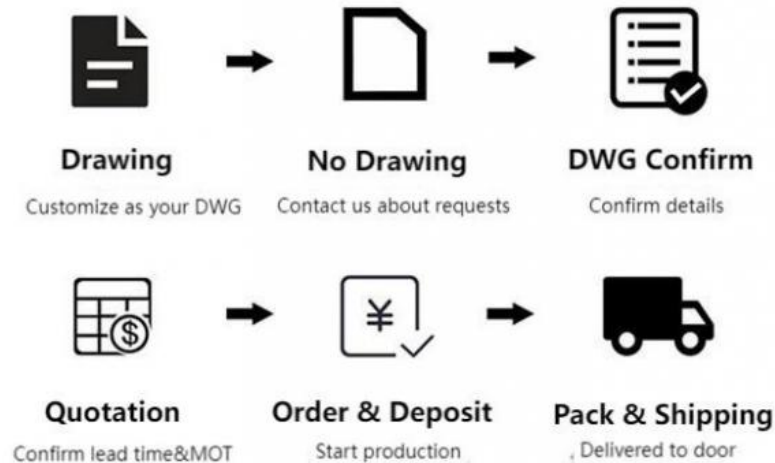

### FAQ

Q: Are you manufacturer or trading company?

A: We are experienced manufacturer in the warehouse storage industry.

Q: How is your delivery time?

A: Generally, it is within 20 days against formal order and deposit. It also depends on other factors such as order quantity.

Q: What is the payment term?

A: T/T 30% as deposit, and 70% before delivery. We'll show you the photos of the products and packages before you pay the balance.

Q: What is your terms of delivery?

A: EXW, FOB

Q: Are samples available?

A: Yes, We can supply the sample if we have ready parts in stock, but the customers have to pay the sample cost and the courier cost.

Q: What is the minimum order quantity?

A: Generally, MOQ is 10sets.

Q: Can I make my own brand and designed products?

A: Yes, we do both OEM and ODM, so you can make your own product with your own logo.

Q: Where is your factory? Can I visit it?

A: Our factory located in Nanjing, Welcome to visit our factory. We can arrange pick-up from the airport or train station for you.

Q: What is the material being used for your products?

A: Mild steel Q235.

Q: I don't have drawing or picture available for the products, could you design it for me?

A: Yes, we can make the best suitable design for you but need to know more details.

Q: Do I get any guarantee from your company?

A: 3 years warranty

Q: How do you make our business long-term and good relationship?

A: Quality makes trust and reputation, plus competitive price to ensure our customers benefit ;



**Jiangsu Qifei Intelligent Storage Equipment Co., Ltd.**



+86-15161451461



sharonyan@qifeirack.com



warehouse-rackings.com

Add: #739 Dixiu Road Jiangning District Nanjing China