

Height 5-15m QF-Gravity Pallet Rack For Smooth Fluent Strips

Basic Information



Product Specification

- Model NO.: QF-Gravity Pallet Rack
- Material: Steel
- Structure: Rack
- Type: Pallet Racking
- Mobility: Fixed
- Height: 5-15m
- Closed: Semi-closed
- Development: New Type
- Serviceability: Common Use
- Color: Customized
- Lead Time: 20 Days
- Raw Material: Q235B
- Surface Treatment: Galvanized/Powder Coating
- Transport Package: Standard Export Packing
- Specification: Customized

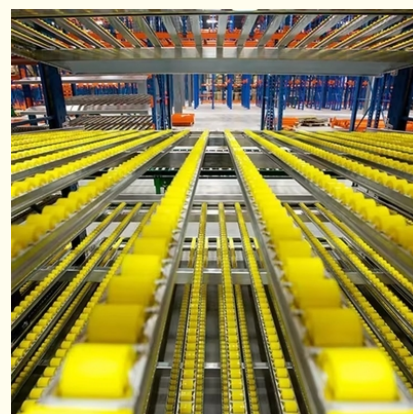

More Images

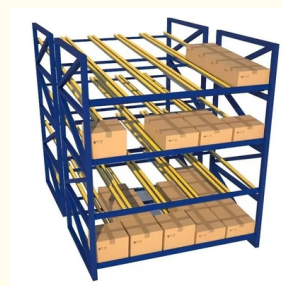

Product Description

Whatever you need, Qifei has all the products and solutions, to make the most out of every section of available space in your storage area.

If you don't know what you're looking for, just contact us.

Product Description

Pallet Flow Racking (FIFO)

Pallet Flow Racking system (Live Storage FIFO) is ideal for warehouses where stock turnover control and space saving are critical.

It consists of a compact structure where each level has linear roller beds that allow the load units to slide easily thanks to a slight inclination.

It is a high-density storage system perfect for storing homogeneous pallets.



How does it work

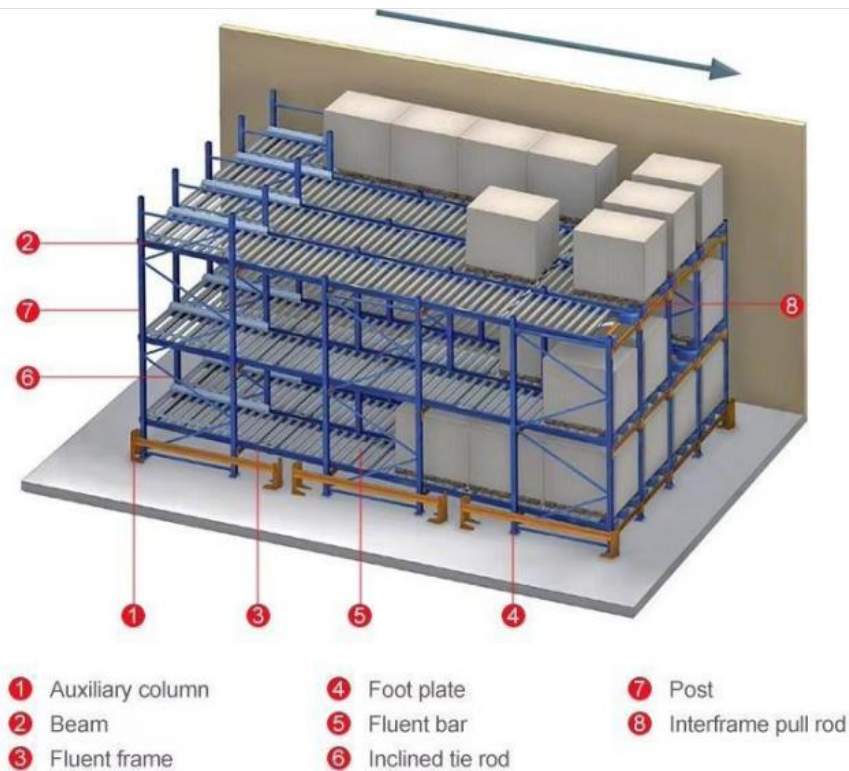



Fluent bar



Roller design



Thick main beam



Anti-collision Angle



Post



Inclined tie rod

Fluent shelf saves labor and improves work efficiency

Fluent shelf are high density dynamic storage systems that increase flexibility and maintain the First-In / First-Out product flow from the stocking aisle to the picking aisle therefore increasing efficiency. fluent shelf permits dense storage by eliminating all aisles except the entrance and exit aisles.



Strong bearing



Easy to install



Adjustable height



Fine workmanship

Exceptional use of space

Suitable for mass storage of similar goods, with plastic or carton use, high spaceutilization rate,widely used in manufacturing, commercial.,assembly workshops and warehouses with high delivery frequency



Fluent shelf working principle

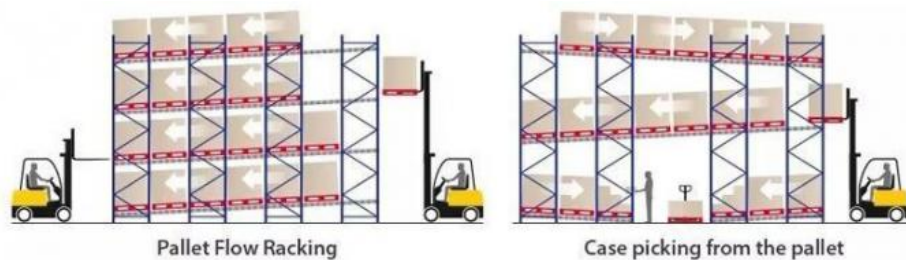

1000mm (1 lane)

2000mm (2 lanes)

Dimensions 3600mm (3 lanes)

Block Height: Up to 13500mm

Channel Depth: Up to 15 pallets deep

Loading Pallet Weight: Up to 1500kg

Uprights: Pre-galvanized

Finish Beams: Pre-galvanized or painted

Accessories: Pre-galvanized or painted

Can be customized to your requirements

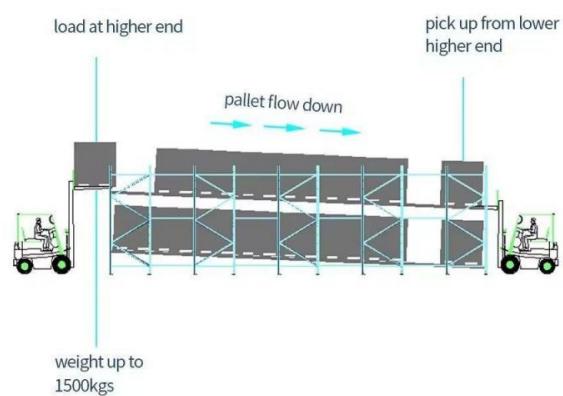

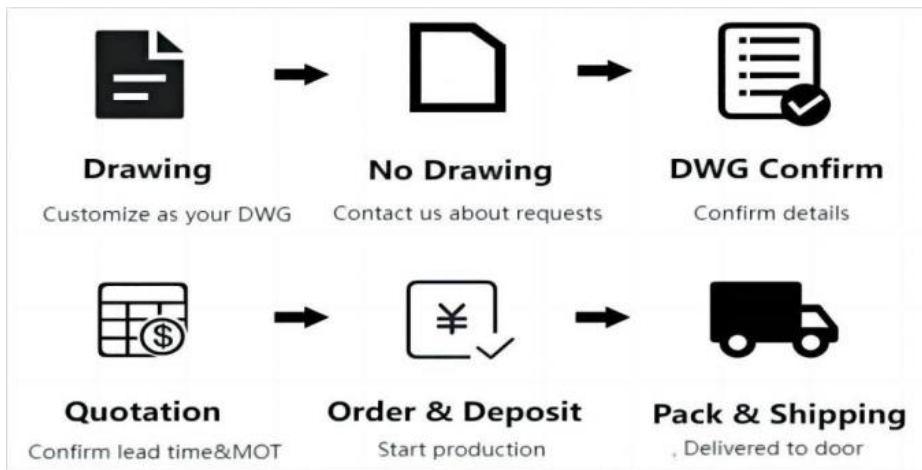

Required information for customized quote

- 1, The AUTOCAD drawing or draft drawing of warehouse or racking.
- 2, Length, Height, and Width of the warehouse.
- 3, Layers of the racking
- 4, Pallet size.
- 5, Max weight of pallet with cargo on.
- 6, Color requirement.

Customer Site





Types of live storage systems

As a general rule, live storage is a compact storage system that uses the force of gravity to store the unit loads. There are live storage systems for both FIFO (First In, First Out) and LIFO warehouse management (Last in, First Out). And also, for any type of load: a solution for heavy loads such as pallets and light loads with systems for cartons.

With their description and operation, divided by the type of unit loads: pallets and cartons (picking):

Pallet Flow Racking systems

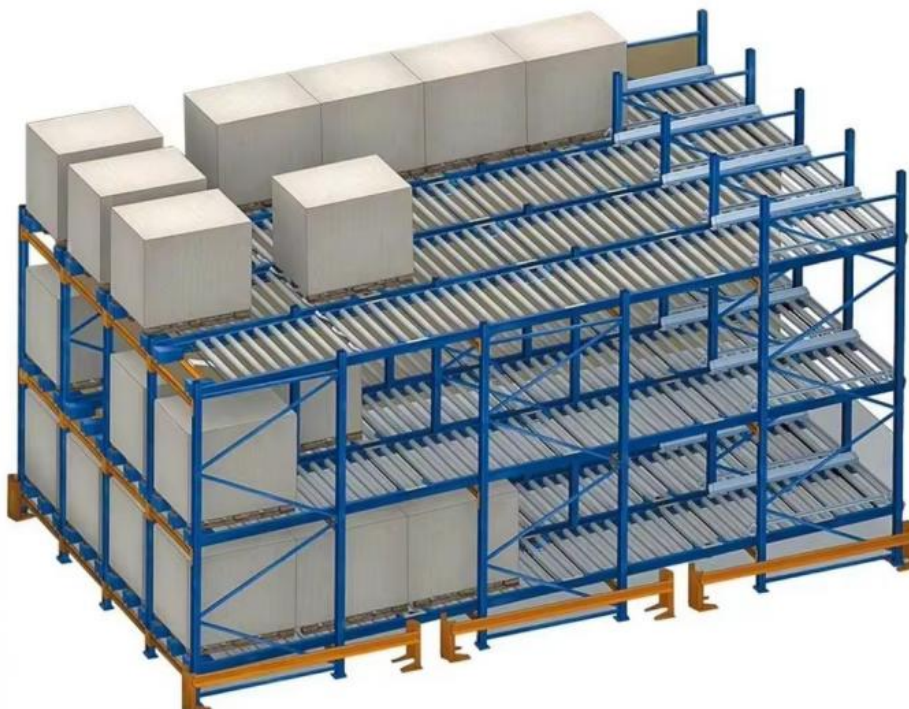

are the most widely used live system of all the existing options.

This storage system consists of a compact metal structure, equipped with a system of roller conveyors on each level with a slight

incline that allow unit loads, generally pallets, to slide freely.

FIFO system, the first pallet in is the first pallet out.

Operation is simple and dynamic, the pallets enter the structure through the loading area, the highest area of the level, and thanks to the incline (4% in most cases) enter the interior of the structure and move along at a controlled speed to the other end, in the unloading area

access mode: First in, first out, last in, last out

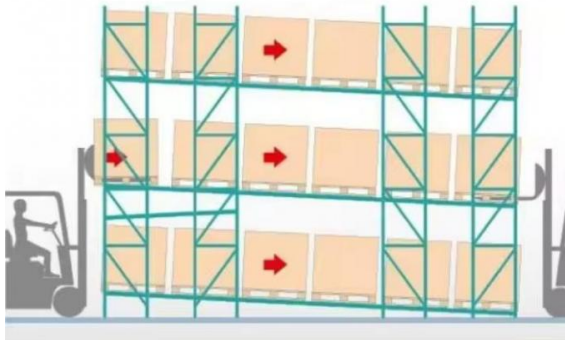

The safety of the system and movement is absolutely guaranteed, thanks to the control, braking and protection measures with which the FIFO live storage systems are equipped.

The separate aisles for the loading and unloading make it possible to separate flows and improve the productivity and safety of the transit of vehicles. It is an ideal solution for products with shorter expiration dates.

Push-back pallet racking systems



unlike gravity live storage, are designed for LIFO type warehouse management, where the last pallet in is the first pallet out. In other words, the loading and unloading process takes place in the same work aisle.

into rack order: 1>2>3

withdraw order: 3>2>1

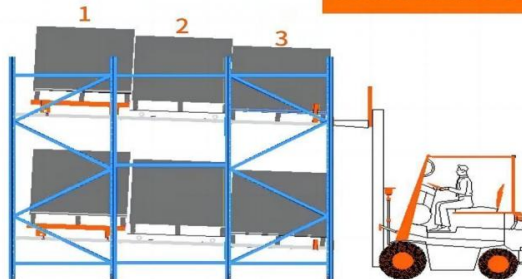

The operation of the push-back pallet racking systems is based on the unit load deposited pushing the previous loads towards the back of the structure, thanks to the system displacement method (rollers or shuttles). For unloading, the slight incline of the rail is exploited so that the pallets slide as they are unloaded.

In short, the pushing force is used for the loading of the pallets and the force of gravity for their unloading.

Carton flow systems



also known as **carton live storage**, are a gravity-controlled high-density compact system to facilitate manual loading tasks. It is a similar system to gravity live pallet racking with the same operation with roller beds and FIFO type warehouse management, but adapted for light loads, usually cartons. The cartons slide on pulley rails from the loading area to the back of the racking, in the unloading area, thanks to a slight incline.

It is the ideal storage system for warehouses with a large volume of picking operations, due to the reduced distance to be travelled by the operators and the time savings in performing operations.

It is a very versatile and high productivity system for the preparation of orders, particularly loose units, allowing for the replenishment of goods without interfering with outward stock movements.

It is also a highly versatile and compatible system with other pallet racking systems.



Packaging & Shipping

Packing



Shipping



MOT AS YOUR REQUEST



AIR FREIGHT FOR URGENT
Transit time: 5-7 days



OCEAN SHIPPING NORMALLY
Transit time: 15-40 days

Company Profile

Welcome to visit our company

Jiangsu Qifei Intelligent Storage Equipment Co., Ltd



Established in 2020, is one of the leading manufacturer specialized in industrial warehouse storage equipment



Main products are heavy/medium/light duty rack, cantilever rack, mezzanine floor, drive in rack, and so on.



We aim to provide cost-effective and space utilization storage solutions for all customers worldwide



FAQ

Q: Are you manufacturer or trading company?

A: We are experienced manufacturer in the warehouse storage industry.

Q: How is your delivery time?

A: Generally, it is within 20 days against formal order and deposit. It also depends on other factors such as order quantity.

Q: What is the payment term?

A: T/T 30% as deposit, and 70% before delivery. We'll show you the photos of the products and packages before you pay the balance.

Q: What is your terms of delivery?

A: EXW, FOB

Q: Are samples available?

A: Yes, We can supply the sample if we have ready parts in stock, but the customers have to pay the sample cost and the courier cost.

Q: What is the minimum order quantity?

A: Generally, MOQ is 10sets.

Q: Can I make my own brand and designed products?

A: Yes, we do both OEM and ODM, so you can make your own product with your own logo.

Q: Where is your factory? Can I visit it?

A: Our factory located in Nanjing, Welcome to visit our factory. We can arrange pick-up from the airport or train station for you.

Q: What is the material being used for your products?

A: Mild steel Q235.

Q: I don't have drawing or picture available for the products, could you design it for me?

A: Yes, we can make the best suitable design for you but need to know more details.

Q: Do I get any guarantee from your company?

A: 3 years warranty

Q: How do you make our business long-term and good relationship?

A: Quality makes trust and reputation, plus competitive price to ensure our customers benefit ;



Jiangsu Qifei Intelligent Storage Equipment Co., Ltd.



+86-15161451461



sharonyan@qifeirack.com



warehouse-rackings.com

Add: #739 Dixiu Road Jiangning District Nanjing China